



ISO 9001 : 2008
Certified Company



JE **Jain Engineers**

Innovative Engineering Solutions



Manufacturer & Exporter of

Mechanical Seals

Pump & Distillery Spares

Bearing Isolators

Agitator Drive Assembly

Biotech Components

Precision Components

***Delivering World Class
Engineering Solutions Since 1995***

Plot No. 1224, 12th Main Road,
KIADB Auto Nagar, Kanbaragi Industrial Area,
Belagavi, Karnataka, India 590015

www.jainseals.com

Off : 0831 - 2459908, 2459841

Mobile : +91-9845096404

+91-9686321404

+91-9008501632

Email ID : jainengineers@gmail.com

Jain Engineers was established in the year 1995 with a mission to manufacture world class products and to provide prompt after sales services to the clients. We at Jain Engineers are passionate about Precision and Perfection. This makes us stand out and effectively describe our range of products. Jain Engineers is a leading Manufacturer and Exporter of Mechanical Seals, Pump & Distillery Spares, Agitator Drive Assembly, Bearing Isolators, Biotech & Precision Components.

We have a well-established 15,000 sq. ft. ultra-modern manufacturing unit at Belagavi, Karnataka with all modern and advanced equipments with ERP and ISO implemented. We have highly qualified engineers and technicians who are engaged in continuous development of products to ensure the best quality products at affordable price and meet the changing trends of global market.

Jain Engineers has earned a reputation for offering some of the most progressive, innovative & proven engineering solutions to the industry. Our objective is to widen our customer base through cost effective solutions in the form of both products and services. We are committed to provide latest technology to our valuable customers with continuous improvement. As Quality Products at Competitive Price are our strength, we are proud to call ourselves as Innovative Engineering Solutions Company.

We are having representatives all over India, Abroad to sell our mechanical seals under the registered trademark "**JAIN SEALS**". Mechanical Seals are available as per ANSI, ISO, DIN & API standards. Seals manufactured by us are comparable to the ones manufactured by Burgmann, John Crane, Pillar, Nippon, Chesterton but available at a competitive price & are serving the Process Industry, Shipping Industries, Dairies, Distilleries, Beverages, Petroleum Industries, Sugar Industries, Thermic Fluids and Chemical Industries. We are having vast clientele all over India as well as abroad like Singapore, Oman, Kingdom of Saudi Arabia, South Africa to name a few.

Executive Team



Mr. Ashok P. Danawade, CEO & MD

Ashok Danawade found Jain Engineers in 1995 and under his leadership the company have grown by leaps and bounds. Today, it has carved a special niche in the industry as Engineering Solutions Company. He has 40 plus years of rich experience in design and manufacturing with more than 20 years spent in mechanical seal industries. He initially worked with Kirloskar Pneumatics Ltd., Keming Tools, Bombay Metal & Alloys Co, General Seal Co to name a few.

Dr. Anil Shirahatti, Director - R & D

Anil is having 16+ years of experience in design and product development. He holds Master degree in Engineering Design & Ph.D. in Mechanical Engineering from University of Bristol, United Kingdom. Throughout his professional career he has been actively engaged in new product development initiatives, from concept to prototype development, through effective project and people management.

Mrs. Anupama A S, Manager - Finance & Marketing

Anupama is having 13+ years of experience in marketing and finance in India and abroad. As a manager of finance & marketing, she provides leadership to sales and marketing team and takes care of finance part of the company. She holds a MBA degree in Entrepreneurship from NMIMS, Mumbai.

Miss. Archana A D, Technical Consultant

Archana is having 10+ years of experience in design of process equipment and components. She has been instrumental in the design and development of process equipment division of the company. She holds a Master degree in Chemical Engineering from Manipal University, Manipal.





Conical Coil Unbalanced Mechanical Seals (JE-1X Series)

Shaft diameter : 10 to 100 mm Pressure : upto 10 bar Speed : upto 3000 rpm
 Temperature : -20 to 180 °C Metal parts : SS316, SS304, Monel, Hastalloy, Alloy-20
 Seal face : Carbon, Tungsten Carbide, Silicon Carbide
 Secondary seals : EPR, Viton™, FEP, Neo-prene, PTFE, Kalrez, EPDM, Nitrile
 Seal Characteristics : Inside mounted, Single acting, Dependent on direction of rotation
 Application : Petrochemicals, General Chemicals, Oil Refineries, Suspended Particles & Slurry, Chemical Process Pumps



Single Spring Coil Unbalanced Mechanical Seals (JE-2X Series)

Shaft diameter : 10 to 160 mm Pressure : upto 10 bar Speed : upto 3000 rpm
 Temperature : -20 to 240 °C Metal parts : SS316, SS304, Monel, Hastalloy, Alloy-20
 Seal face : Carbon, Tungsten Carbide, Silicon Carbide
 Secondary seals : EPR, Viton™, FEP, Neo-prene, PTFE, Kalrez, EPDM
 Seal Characteristics : Inside mounted, Single acting, Independent of direction of rotation
 Application : Petrochemicals, General Chemicals, Oil Refineries, Suspended Particles & Slurry



Single Spring Coil Unbalanced Mechanical Seals (JE-3X Series)

Shaft diameter : 12 to 150 mm Pressure : upto 30 bar Speed : upto 3000 rpm
 Temperature : -20 to 240 °C Metal parts : SS316, SS304, Monel, 904L, Alloy-20
 Seal face : Carbon, Tungsten Carbide, Silicon Carbide
 Secondary seals : Viton™, PTFE, GFT, EPDM
 Seal Characteristics : Inside mounted, Single acting, Independent of direction of rotation
 Application : Petrochemicals, General Chemicals, Refineries, Suspended Particles, Mild Slurry, High Pressure Pumps, Nuclear & Fertilizer Plants



Elastomer Bellow Mechanical Seals (JE-4X Series)

Shaft diameter : 12 to 100 mm Pressure : upto 10 bar Speed : upto 3000 rpm
 Temperature : -20 to 200 °C Metal parts : SS316, SS304
 Seal face : Carbon, Tungsten Carbide, Silicon Carbide
 Secondary seals : Viton™, Nilon, EPDM, Nitrile, Neoprime
 Seal Characteristics : Inside mounted, Single acting, Dependent on direction of rotation
 Application : Sewage Applications, Hot & Cold Water Pumps, Waste Water Pumps, Fuel Injection Pumps



Rubber Bellow Mechanical Seals (JE-5X Series)

Shaft diameter : 12 to 90 mm Pressure : upto 10 bar Speed : upto 3000 rpm
 Temperature : -20 to 180 °C Metal parts : SS316, SS304, Monel, Hastalloy, Alloy-20
 Seal face : Carbon, Tungsten Carbide, Silicon Carbide
 Secondary seals : Viton™, EPR, FEP, Neo-prene, PTFE, Kalrez, Nitrile
 Seal Characteristics : Inside mounted, Single acting, Dependent on direction of rotation
 Application : Water & Sewage Applications, Light Chemicals, Polymer Industry



Wave Spring Mechanical Seals (JE-6X Series)

Shaft diameter : 18 to 100 mm Pressure : upto 10 bar Speed : upto 3000 rpm
Temperature : -20 to 240 °C Metal parts : SS316, SS304, 904L, Alloy-20
Seal face : Carbon, Tungsten Carbide, Silicon Carbide
Secondary seals : Viton™, PTFE, EPDM
Seal Characteristics : Single acting, Balanced/Unbalanced, Independent of direction of rotation,
Spring is Isolated from Product
Application : Purification Plants, Pulp & Paper, Chemical, Petrochemical & Sugar
Industries, Brewery & Pharmaceutical Applications



Metal Bellow Mechanical Seals (JE-7X Series)

Shaft diameter : 19 to 102 mm Pressure : upto 15 bar Speed : upto 3000 rpm
Temperature : -20 to 400 °C Metal parts : SS316, SS304, Monel, Hastalloy, Alloy-20
Seal face : Carbon, Tungsten Carbide, Silicon Carbide
Secondary seals : Viton™, PTFE, Neoprene, Kalrez, Graphite
Seal Characteristics : Inside Mounting, Single acting, Balanced/Unbalanced, Independent of
direction of rotation, Spring is Isolated from Product
Application : Petrochemicals, General Chemicals, Oil Refineries, Thermic Fluids,
High Temperature Applications



PTFE Mechanical Seals (JE-8X Series)

Shaft diameter : 16 to 100 mm Pressure : upto 10 bar Speed : upto 1400 rpm
Temperature : -20 to 120 °C Metal parts : SS316, SS304, Monel, Hastalloy, Alloy-20
Seal face : Carbon, GFT, Silicon Carbide, Ceramic
Secondary seals : PTFE, GFT
Seal Characteristics : Inside Mounting, Single acting, Independent of direction of rotation
Application : Chemicals, Aggressive Corrosive Applications, Acids, Alkalis



Grundfos Cartridge Mechanical Seals (JE-9X Series)

Shaft diameter : 10 to 200 mm Pressure : upto 10 bar Speed : upto 3000 rpm
Temperature : -20 to 180 °C Metal parts : SS316, SS304, Monel, Hastalloy, Alloy-20
Seal face : Carbon, Tungsten Carbide, Silicon Carbide
Secondary seals : Viton™, EPDM, NBR
Seal Characteristics : Inside Mounting, Single acting, Unbalanced, Independent of direction
of rotation
Application : Grundfos Pumps, General Chemicals, Oil Refineries, Food & Beverages,
Mining Industries



Multi Spring Unbalanced Mechanical Seals (JE-10X Series)

Shaft diameter : 12 to 150 mm Pressure : upto 15 bar Speed : upto 3600 rpm
Temperature : -20 to 180 °C Metal parts : SS316, SS304, Hastalloy, Alloy-20
Seal face : Carbon, Tungsten Carbide, Silicon Carbide
Secondary seals : Viton™, EPR, FEP, PTFE, GFT, Neo-prene, Kalrez
Seal Characteristics : Inside Mounting, Single acting, Independent of direction of rotation
Application : Petrochemicals, General Chemicals, Oil Refineries, Food & Beverages,
Industrial Fluids



Multi Spring Reversed Unbalanced Mechanical Seals (JE-11X Series)

Shaft diameter : 12 to 150 mm Pressure : upto 10 bar Speed : upto 3000 rpm
 Temperature : -40 to 180 °C Metal parts : SS316, SS304, Hastalloy, Alloy-20
 Seal face : Carbon, Tungsten Carbide, Silicon Carbide
 Secondary seals : Viton™, EPR, FEP, PTFE, Neo-prene, Kalrez
 Seal Characteristics : Inside Mounting, Single acting, Independent of direction of rotation
 Application : Corrosive Chemicals, Hydrocarbons, Acid & Acidic Atmosphere



Multi Spring Balanced Mechanical Seals (JE-12X Series)

Shaft diameter : 18 to 150 mm Pressure : upto 20 bar Speed : upto 3000 rpm
 Temperature : -20 to 220 °C Metal parts : SS316, SS304, Hastalloy, Alloy-20, 904L
 Seal face : Carbon, Tungsten Carbide, Silicon Carbide
 Secondary seals : Viton™, EPR, FEP, PTFE, Neo-prene, Kalrez
 Seal Characteristics : Inside Mounting, Single acting, Independent of direction of rotation
 Application : Petrochemicals, General Chemicals, Oil Refineries, Food & Beverages, Industrial Fluids



Capsulated Multi Spring Balanced Mechanical Seals (JE-13X Series)

Shaft diameter : 18 to 100 mm Pressure : upto 25 bar Speed : upto 3000 rpm
 Temperature : -20 to 200 °C Metal parts : SS316, SS304, Hastalloy, Alloy-20
 Seal face : Carbon, Tungsten Carbide, Silicon Carbide
 Secondary seals : Elastomer, PTFE, GFT
 Seal Characteristics : Inside Mounting, Single acting, Independent of direction of rotation, Spring is Isolated from Product
 Application : General Chemicals, Slurry Applications, Medium Containing Solid Particles, Acids & Alkalies



Multi Spring Double Mechanical Seals (JE-14X Series)

Shaft diameter : 16 to 150 mm Pressure : upto 10 bar Speed : upto 3000 rpm
 Temperature : -20 to 250 °C Metal parts : SS316, SS304, Hastalloy, Alloy-20
 Seal face : Carbon, Tungsten Carbide, Silicon Carbide
 Secondary seals : EPR, FEP, PTFE, Neo-prene, Kalrez
 Seal Characteristics : Inside Mounting, Single acting, Independent of direction of rotation
 Application : Petrochemicals, General Chemicals, Oil Refineries, Heat Temperature Pumps



Single Cartridge Mechanical Seals (JE-15X Series)

Shaft diameter : 25 to 150 mm Pressure : upto 15 bar Speed : upto 3000 rpm
 Temperature : -20 to 250 °C Metal parts : SS316, SS304, 904L, Alloy-20
 Seal face : Carbon, Tungsten Carbide, Silicon Carbide
 Secondary seals : PTFE, GFT, FFKM
 Seal Characteristics : Inside Mounting, Single acting, Balanced / Unbalanced, Independent of direction of rotation
 Application : Petrochemicals, Petroleum Refineries, Paper Industries, Sludge and Syrup Pump, Slurry Pump



Double Cartridge Mechanical Seals (JE-16X Series)

Shaft diameter : 25 to 150 mm Pressure : upto 15 bar Speed : upto 3000 rpm
 Temperature : -20 to 250 °C Metal parts : SS316, SS304, 904L, Alloy-20
 Seal face : Carbon, Tungsten Carbide, Silicon Carbide
 Secondary seals : PTFE, GFT, FFKM
 Seal Characteristics : Inside Mounting, Single acting, Balanced / Unbalanced,
 Independent of direction of rotation
 Application : Petrochemicals, Petroleum Refineries, Paper Industries, Sludge and
 Syrup Pump, Slurry Pump



Metal Bellow Cartridge Mechanical Seals (JE-17X Series)

Shaft diameter : 25 to 150 mm Pressure : upto 20 bar Speed : upto 3000 rpm
 Temperature : -45 to 400 °C Metal parts : SS316, SS304, Monel, Hastalloys
 Seal face : Carbon, Tungsten Carbide, Silicon Carbide
 Secondary seals : PTFE, GFT, Kalrez
 Seal Characteristics : Inside Mounting, Single acting, Balanced / Unbalanced,
 Independent of direction of rotation
 Application : Sludge Pumps, Pulp & Syrup Pumps, Oil Pipeline Pumps and
 Boiler Feed Water Pumps



Double Acting Agitator Mechanical Seals (JE-18X Series)

Shaft diameter : 25 to 200 mm Pressure : upto 35 bar Speed : upto 1000 rpm
 Temperature : -20 to 240 °C Metal parts : SS316, SS304, Monel, Hastalloys, Alloy-20
 Seal face : Carbon, Tungsten Carbide, Silicon Carbide
 Secondary seals : PTFE, Kalrez, EPDM, FEP
 Seal Characteristics : Inside Mounting, Single acting, Balanced / Unbalanced,
 Independent of direction of rotation
 Application : Petrochemicals, Food Industry, Pharmaceutical, General Chemicals



Dry Agitator Mechanical Seals (JE-19X Series)

Shaft diameter : 25 to 150 mm Pressure : upto 15 bar Speed : upto 1000 rpm
 Temperature : -20 to 120 °C Metal parts : SS316, SS304, Monel, Hastalloys, Alloy-20
 Seal face : Carbon, Tungsten Carbide, Silicon Carbide
 Secondary seals : PTFE, Kalrez, FEP, Nitrile, FEP, EPR
 Seal Characteristics : Inside Mounting, Single acting, Balanced / Unbalanced,
 Independent of direction of rotation
 Application : General Chemicals, Petrochemicals, Food & Pharmaceutical Industry



High Pressure Mechanical Seals (JE-20X Series)

Shaft diameter : 25 to 150 mm Pressure : upto 15 bar Speed : upto 2500 rpm
 Temperature : -40 to 200 °C Metal parts : SS316, SS304, Alloy-20
 Seal face : Carbon, Tungsten Carbide, Silicon Carbide
 Secondary seals : Viton™, PTFE, GFT
 Seal Characteristics : Inside Mounting, Single acting, Balanced, Independent of direction
 of rotation
 Application : High Pressure Pumps, Refineries, Fertilizers, Nuclear Plants and
 Petroleum Products



Bearing Isolators

Oil seals will lead to wear out of the shaft at rubber contact place resulting in bearing failure due to oil leakage at gearbox and expensive downtime. With Bearing Isolators installation, one can reduce maintenance costs and increase the life of the shaft. The Bearing Isolator is a two part dynamic seal consisting of a stator and a rotor attached to the shaft. The rotor and stator form a non-contacting compound labyrinth seal with no wearing parts – ensuring permanent protection.

Shaft Size : 15 - 250 mm

Materials: Bronze, Stainless Steel, Aluminium Alloy

Agitator drive assembly with mechanical seal



We design and manufacture wide range of agitator drive assemblies with mechanical seals. These agitators are widely used for high viscous media, gentle mixing and work upto speed of 400 rpm. We supply the agitator drive assembly with mechanical seal for fermentators for capacity ranging from of 2 litres to 1500 litres.

Additional services provided by Jain Engineers

Jain Engineers are having vast clientele in all over India as well as abroad like Singapore, Oman, Kingdom of Saudi Arabia, South Africa etc. We offer additional services like high precision machining, consulting, reconditioning of mechanical seals and rotary union joints, lapping, fitting, after sales services and technical support in mechanical seals. We provide total solution to our esteemed customers with matchless consistency and superior performance.

Lapping Services

Reconditioning of Mechanical Seals

Mechanical Seal Fitting & Training

Reconditioning of Rotary Union Joints

Consultancy

New Product Development

High Precision Machining Jobs

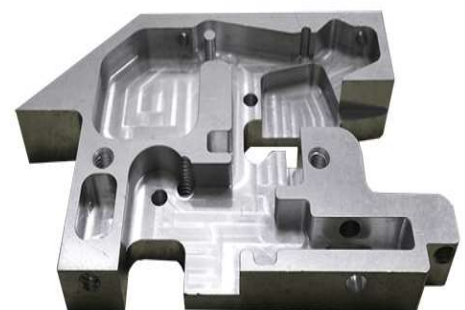

3D Printing Machines

FDM and SLA based 3D-Printers are developed as part of New Product development program for ATTIS Systems, Hong Kong.

FDM Printer :

Bed size 130 x 150 x 100 mm ; 100 microns Accuracy

SLA Printer :

Bed size 120 x 120 x 150 mm ; 50 microns Accuracy

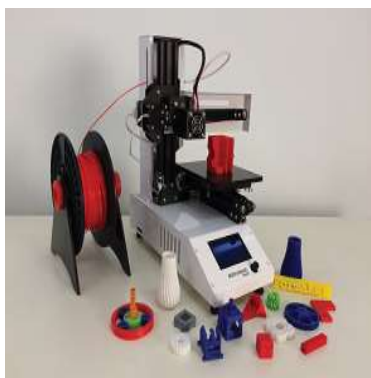

Attrobot Mini



SLA ATDS 120



National Award Winner
as Best Entrepreneur



MSME Super Tycoon Award 2017
by ASSOCHAM



Award for Manufacturing Excellence
by Government of Karnataka



Rotary BSE-SME National Award
for Excellence in "Import
Substitution" in AdAstra—2016.



Dilip Damle Memorial Trust award
for Excellence in Industrial Product
Development & Manufacturing



Award for outstanding performance in
Innovation and Creativity in Karnataka
from KASSA.



Jain Engineers at International Exhibitions



Factory visited by Mr. Darpan Jain, Joint Secretary
Department of Commerce, Government of India



Delegate for India UK SME's Conference and Buyer Seller Meet in Leicestershire, United Kingdom

Testimonials

In our plant, Inboard mechanical seal have huge leakage & failure was high due to slurry, solids with wastage & solids. Jain Engineers developed and supplied a unique outside mounted mechanical seal. The mechanical seal supplied has more service life, less maintenance and cost effective. We expect more expert engineering solutions in future from them.

Executive Vice President , Siddapur Distilleries Ltd.

Jain Engineers is associated with our power plant since 2001 for the development of mechanical seals, rubber o-rings and gaskets. The mechanical seals supplied by them are direct substitution to Burgman & John Crane Seals. Developed o-rings and gaskets have been successfully used in Wastfalia separators and the Engine fuel injection system.

Plant Manager, Tata Power

For more than two decades Jain Engineers is supplying all types of mechanical seals to our sugar and distillery plants. We are extremely happy & satisfied with their competitive price & after sales and service. We also appreciate the innovative solutions provided by them for our practical problems.

Purchase Manager, Shree Renuka Sugars Ltd.

Jain Engineers is supplying agitator drive assembly with mechanical seals for our fermentator from capacity of 2 litres to 1500 litres. We highly appreciate their technical knowledge & manufacturing facility. We are satisfied with their after sales and service at our different installations in India & Abroad.

CMD, Dyna Biotech

Jain Engineers have supplied Labrynth Seals for Vertical Pans Mechanical Circulator in place of existing double cartridge type of mechanical seals. The fitted seals have given very good results in operation without any leakage. We have saved all around rupees five lakhs by adopted their innovative solution.

General Manager Technical, Godavari Biorefineries Ltd.

Jain Engineers is supplying mechanical seals for our beverages plant for more than two decades. The Engineering Solution provided by them is highly appreciated in Industry. Also their prices are highly competitive and after sales and service is satisfactory.

Purchase Manager, Coco Cola

Our Esteemed Customers



Corporate Social Responsibility (CSR)

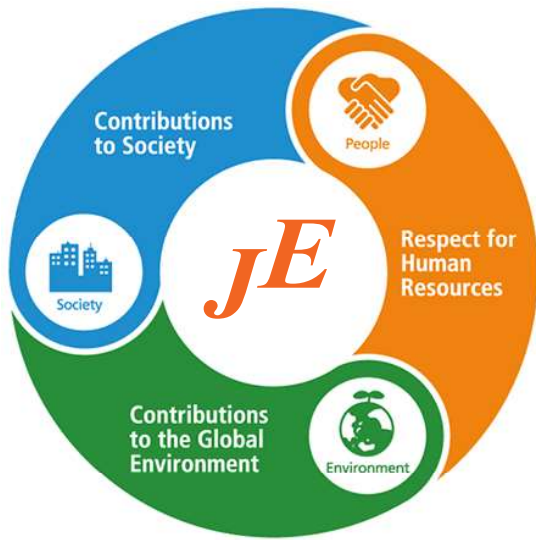

Corporate Social Responsibility (CSR) is a concept that suggests that it is the responsibility of the corporates operating within the society to contribute towards economic, social & environmental development that creates positive impact on society at large. Although there is no fixed definition, the concept revolves around the fact that even the corporates need to focus beyond earning profits. For us at Jain Engineers, it's a simple way to solve society's problems through innovative solutions. We believe in inclusive growth and making the society we live in a harmonious place that cultivates knowledge and provides a platform for sustainable growth.

We frequently take time off from work to engage in social activities, which include education, healthcare & community service. As a part of CSR activities, one of our initiatives includes providing financial support for underprivileged children's education to help in reducing socio-economic disparities. We are also actively involved in sharing our knowledge and experience through industrial institute interaction to develop future engineers and entrepreneurs.



Our Facility





ISO 9001 : 2008



Jain Engineers
Innovative Engineering Solutions



Delivering World Class Engineering Solutions Since 1995

Sales Network

Mumbai
Pune
Ahmedabad

New Delhi
Hyderabad
Cochin

Bangalore
Chennai
Goa

Mangalore
Vijayawada
Hong Kong

Oman
Dubai
Singapore

Jain Engineers

Plot No. 1224, 12th Main Road,
KIADB Auto Nagar, Kanbaragi Industrial Area,
Belagavi, Karnataka, India 590015

Jain Seals

Plot No. 1221, 13th Main Road,
KIADB Auto Nagar, Kanbaragi Industrial Area,
Belagavi, Karnataka, India 590015

Off : 0831 - 2459908, 2459841 Mobile : +91-9845096404, 9686321404, 9008501632

Email ID : jainengineers@gmail.com

www.jainseals.com